



VIEWCD
Client Devices

ARIA 6

HIGH PERFORMANCE, FLEXIBLE HEVC
HYBRID TV DEVICE, WITH A VARIETY OF
TUNER OPTIONS, OPTIMISED FOR THE
COST EFFECTIVE DELIVERY OF COMBINED
BROADCAST AND IPTV / OTT SERVICES.



With the Aria 6 series of TV devices, operators are able to provide these next generation of services in the highest possible resolutions while reaping the cost benefits of reduced bandwidth and installation times.

Deliver Hybrid TV Services Anywhere, Anytime

By providing a tuner that supports a wide range of broadcast standards, including DVB-T2, DVBC and ISDB-T, Aria enables you to quickly deploy a Hybrid TV service within your market reach, while also allowing you to expand outside your service footprint.

With a high performance SoC delivering 6000 DMIPS – and up to 1GB of memory – the Aria 6 offers:

- Optimized for digital video broadcast and streaming media services
- Reduce bandwidth by up to 50% with HEVC support
- Self-configuring Ethernet port and optional WiFi connectivity for easy integration with existing in-home networks and broadband services
- Energy efficient with DeepSleep™ technology for reducing power consumption up to 99% in standby mode

Reduce Bandwidth, Reduce Costs

Studies have shown that H.265/HEVC provides up to 50% better compression than H.264/AVC and 35% bandwidth reduction during live encoding. HEVC compression provides significant benefits to your network by reaching subscribers in the “last mile” that were previously difficult to reach. As a result, you can reduce bandwidth and transport costs, while delivering much higher quality content over Content Delivery Networks (CDN) or streaming content to lower bitrate connections.

TO FIND OUT MORE PLEASE
CONTACT AN AMINO
REPRESENTATIVE BY EMAILING:

info@aminocom.com



IP Connectivity

Aria 6 series provides flexible networking options to simplify installation and enable consumer self-install. Aria is equipped with a self-configuring 10/100 Ethernet port that is compatible with industry standard routers, cable and xDSL modems, and FTTH ONUs.

Reduce installation time, cost and complexity of wiring a home with Aria's 802.11n (2.4 GHz) Wi-Fi networking option.

Aria can operate in IPv4 or IPv6, making it compatible with the billions of IPv4 devices that have already been deployed as well as IPv6 networks that will be deployed in the future.

Aria provides auto-provisioning tools such as BOOTP, DHCP and TR-069 Automatic Configuration Server to make deployment and management faster and more efficient.

Cloud-based Applications for a Connected Home Experience

Meet subscriber's demand by offering the most advanced online services and applications. Based on Broadcom's latest chipset, Aria 6 series supports streaming video services like Netflix, VUDU, and YouTube*.

Ready-to-Deploy Hybrid TV Solution

By supporting all of Amino's ecosystem partners, including the latest digital rights management developments and conditional access solutions, Aria 6 enables you to quickly deploy a video service that also provides advanced cloud-based features for hybrid IPTV and over-the-top (OTT) streaming applications.

Supports Legacy Televisions

Broaden your addressable homes by supporting the millions of televisions in subscriber homes that do not support HDMI. Aria 6 supports composite video, as well as analog stereo audio and digital multi-channel audio outputs.

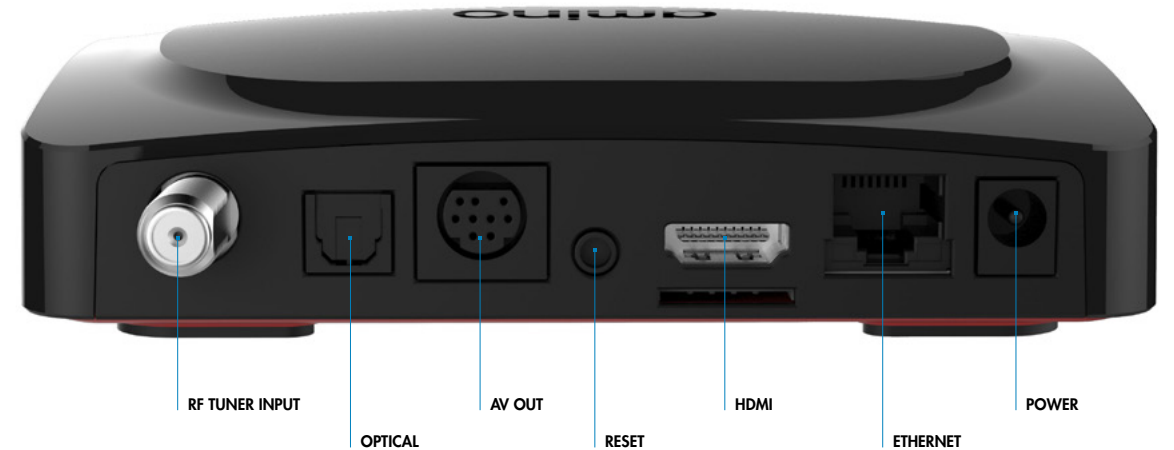

*Online services and applications may vary and are subject to middleware and third-party support.

SPECIFICATIONS

VIDEO FORMATS

VC-1 Advanced Profile @ Level 3
AVC/H.264 High Profile @ Level 4.2
H.265 High Efficiency Video Coding (HEVC)
Main Profile and Main 10 Profile
MPEG-2 Main Profile @ High Level
MPEG-4 Part 2 Advanced Simple Profile
DivX versions 3.11, 4.1, 5.X, and 6.X
XVID
MPEG-1/H.261/H.263
AVS decode
with support for AVS1-P2 Jizhun Profile @ Level 6.0
MPEG still picture decode
MVC
VP9 (for YouTube)

AUDIO FORMATS

AAC LC, AAC LC+SBR Level 2, AAC HE Level 2,
AAC HE Level 4
AC4
Dolby Digital, Dolby Digital Plus
MPEG I Layer 1, 2
MPEG I Layer 3 (MP3) encode/decode
Windows® Media Audio (WMA)
WMA pro
AAC HE 5.1 decode plus DTS 5.1 encode SPDIF
output
AAC HE 5.1 decode plus AC3 5.1 encode SPDIF
output

VIDEO OUTPUTS

NTSC-M, NTSC-J, PAL-BDGHIN, PAL-M, PAL-Nc,
SECAM analog outputs
480i/480p/576i/576p/720p/1080i/1080p/4K-
2KP60 output formats
Component RGB or YPrPb output
DCS support
Rovi 7.1 support
HDMI 2.0 with 3D format support

SECURITY

AES, 1DES, 3DES, CPRM, CPPM, CSS, and DTCP
copy protection algorithms and standards
VB, ARIB, and DC2-compliant transport demux with
1DES, 3DES, DVB, Multi2, and AES descramblers

TUNERS

Cable
36~1002 MHz channel frequency range
Fully compliant to ETSI EN 300 429 and 1 GHz
SCTE-40
Variable symbol rate (1.0~7.2 MHz) QPSK, 256-
QAM demodulator
36~1002 MHz channel frequency range

DVB-T2
Performance exceeding NorDig Unified 2.2 and
D-Book 7
Fully compliant with ETSI EN 300 744 (DVB-T) and
ETSI EN 302 755 (DVB-T2)
1.7, 5, 6, 7, and 8 MHz channels ITU J.83 Annex
A/B/C compatible FEC decoder with RS erasure

ISDB-T
36~1002 MHz channel frequency range
ISDB-T time interleaving (Mode 3: l = 0, 1, 2,
4; Mode 2: l = 0, 2, 4, 8; Mode 1: l =
0, 4, 8, 16)
D-QPSK, 4, 16, 64-QAM (ISDB-T) with full support
for hierarchical modes
5, 6, 7, and 8 MHz channels

NETWORKING OPTIONS

Internal 802.11n (2.4 GHz) 2x2 Wi-Fi
Baseband 2T2R, up to 2 spatial streams
Standards: 802.11h, 802.11b/g/n, 802.11e,
802.11i
Wi-Fi Compliant: WMM, WMM-PS, WPA, WPA2,
WPS
Encryption: AES, TKIP, WEP64/128
RF: 2.4GHz – 2.4835GHz
Modulations: BPSK, QPSK, 16-QAM, 64-QAM
FEC: 1/2, 2/3, 3/4, 5/6
Max PHY Rate: 300Mbps

FRONT & SIDE PANELS

Illuminated standby indicator (on/standby)
IR receiver

BACK PANEL

Connectors
Optical digital audio
Coaxial RF Output and Antenna Input
Mini DIN connector for composite video & stereo
audio fan-out cable (included)
HDMI 2.0
USB 2.0 Host Type A
IR Extender Port
RJ-45 10/100 Base-T Ethernet with integrated status
LEDs
DC power
Reset to factory

CPU & MEMORY

Broadcom BCM7250
6K DMIPS, dual-core ARM-v7 CPU
1GB SDRAM
256MB + 4MB SPI Flash

MECHANICAL

134w x 113d x 34h mm
5-35°C (40-95°F) operating temperature
30-95% relative humidity

ENERGY MANAGEMENT

Power 7W maximum at 90-264VAC, 48-63Hz
ENERGY STAR compliant

TYPE APPROVALS

FCC Part 15, CEA-60065



Global Headquarters

Buckingway Business Park,
Anderson Road, Swavesey,
Cambridge, CB24 4UQ, UK

Tel: +44 (0) 1954 234 100

Email: info@aminocom.com

**Amino Communications Ltd is a wholly owned
subsidiary of Amino Technologies plc**

Amino and the Amino Logo are trademarks of Amino Communications Limited. All other trademarks are the property of their respective owners. © Amino Communications Ltd. 20/11/15. AM-007974-AW-17 HDMI, The HDMI Logo High Definition Multimedia Interface are trademarks or registered trademarks of HDMI licencing LLC

 **@AminoTV**

 **aminocom.com**

POWERED BY

ENABLE TV Software
Platform